

APPENDIX 1

COPY OF CURRENT LICENSE

## PREMISES LICENCE

Receipt: AG763331

Premises Licence Number: LN00002133

*This Premises Licence has been issued by:*

**The Licensing Authority, London Borough of Haringey,  
Civic Centre, High Road, Wood Green,  
London, N22 8LE**

Signature:.....

Date: 24<sup>TH</sup> November 2005

### Part 1 – PREMISES DETAILS

Postal Address of Premises or, if none, Ordnance Survey map reference or description:

**THE SWAN  
363 HIGH ROAD  
TOTTENHAM,  
LONDON  
N17 6QN**

Telephone: 020 8808 1542

Where the Licence is time limited, the dates:

N/A

Licensable activities authorised by the Licence:

**Regulated Entertainment:** Films, Live Music, Recorded Music, Provision of Facilities for Making Music & Dancing

**Provision of Late Night Refreshment**

**Supply of Alcohol**

The times the Licence authorises the carrying out of licensable activities:

#### Films

**Monday to Sunday                      1100 to 2300**

**Live Music, Recorded Music, Provision of Facilities for Making Music and Dancing**

**Mondays to Wednesday              2000 to 0000**

**Thursday to Saturday                2000 to 0300**

**Sunday                                      2000 to 0100**

**Provision of Late Night Refreshment**

**Monday to Wednesday                2300 to 0030**

**Thursday to Saturday                 2300 to 0330**

LICENSING ACT 2003

Sec 24

Sunday 2300 to 0100

Supply of Alcohol

Monday to Wednesday 1000 to 0000

Thursday to Saturday 1000 to 0300

Sunday 1200 to 0030

New Years Eve licensable activities from the start of permitted hours on 31 December until the start of permitted hours on 1 January.

An additional hour of licensable activities Saturdays and Sundays before Bank Holidays and Christmas Eve.

The opening hours of the premises:

Monday to Wednesday 1000 to 0030

Thursday to Saturday 1000 to 0330

Sunday 1200 to 0100

New Years Eve opening hours from the start of permitted hours on 31 December until the start of permitted hours on 1 January.

An additional hour Saturdays and Sundays before Bank Holidays and Christmas Eve.

No new admission to the premises after 0000 every night

Where the Licence authorises supplies of alcohol whether these are on and/or off supplies:

Supply of alcohol for consumption both **ON** and **OFF** the premises.

Part 2

Name, (registered) address, telephone number and e-mail (where relevant) of holder of Premises Licence:

Mr Paul Bruce  
C/o: THE SWAN  
363 HIGH ROAD  
TOTTENHAM, LONDON  
N17 6QN

Mr Peter Whyte  
9 Thorne Close  
Leytonstone  
London  
E11 4HU

LICENSING ACT 2003

Sec 24

**Registered number of holder, for example company number, charity number (where applicable):**

**Name, address and telephone number of designated premises supervisor where the Premises Licence authorises the supply of alcohol:**

Mr Paul Bruce  
C/o: THE SWAN  
363 HIGH ROAD  
TOTTENHAM, LONDON  
N17 6QN

**Personal Licence number and issuing authority of personal licence held by designated premises supervisor where the Premises Licence authorises for the supply of alcohol:**

LN00001285

Issued by London Borough of Haringey

Expires: 25<sup>th</sup> November 2015

## **Annex 1 –Mandatory Conditions**

**(2) Supply of alcohol:** No supply of alcohol may be made under the premises licence-

- (a) at a time when there is no designated premises supervisor in respect of the premises licence, or
- (b) at a time when the designated premises supervisor does not hold a personal licence or his personal licence is suspended.

(3) The second condition is that every supply of alcohol under the premises licence must be made or authorised by a person who holds a personal licence.

### **Exhibition of films:**

(2) Where the film classification body is specified in the licence, unless subsection (3) (b) applies, admission of children must be restricted in accordance with any recommendation made by that body.

(3) Where-

- (a) the film classification body is not specified in the licence, or
  - (b) the relevant licensing authority has notified the holder of the licence that this subsection applies to the film in question,
- admission of children must be restricted in accordance with any recommendation made by that licensing authority.

(4) In this section-

“children” means persons aged under 18; and

“film classification body” means the person or persons designated as the authority under section 4 of the Video Recordings Act 1984.

**Door supervision:** At specified times one or more individuals must be at the premises to carry out a security activity and each of these individuals must be licensed by the Security Industry Authority.

## **Annex 2 – Conditions consistent with the Operating Schedule**

### **THE PREVENTION OF CRIME AND DISORDER**

That CCTV be installed, maintained and operated on the premises for the duration of operating hours for the prevention of crime and disorder.

CCTV system to be recording at all times when the premises are open and the recordings shall be made available to the police and council on request.

Anti-Drugs signs will be displayed on the premises.

Two door supervisors will be present between 22.00 and the closing of the premises.

### **PUBLIC SAFETY**

Fire safety equipment will be checked regularly and any requirements made by the Fire Safety Officer will be complied with.

The maximum number of persons accommodated at any one time shall not exceed:

Restaurant: 50

Bar Area: 150

The inward opening gate to Philip Lane and the inward opening doors to the High Road shall be kept locked in the open position whilst the premises are open to the public.

All Certificates required by the Council to be submitted promptly when they become due.

### **THE PREVENTION OF PUBLIC NUISANCE**

Signs will be displayed at the exit reminding customers to leave quietly and respect the neighbours.

Staff will call Taxis/ Mini cabs for the use of customers leaving the premises when requested to do so.

No new admission to the premises after 00:00 every night.

### **THE PROTECTION OF CHILDREN**

All staff will be trained that alcohol will only be sold to persons who can produce photographic identification where there is any doubt that they are over the age of 18.

Persons under the age of 18 will not be permitted to use Gaming machines.

No persons under the age of 18 will be admitted into the back bar when 18 certificate films are being shown.

Alcohol may only be sold to individuals over the age of 18 with valid proof of identification with one of the following:

- A valid passport
- A photo driving license issued in a European Union Country
- A proof of age standard card system
- A citizen card, supported by the Home Office

### **Annex 3 – Conditions attached after a hearing by the licensing authority**

That the Committee grants the application in part and subject to the following conditions:

- (i) Conditions to enforce the operating schedule to ensure the Licensing objectives are met.
- (ii) Impose recommendations of the Child Protections Agency on age restrictions to meet the crime prevention objective.
- (iii) Standard mandatory conditions are enforced.
- (iv) Hours of operation are as follows
  - Sale of Alcohol is Monday to Wednesday 10:00 to 00:00; Thursday to Saturday 10:00 to 03:00; and Sunday 12:00 to 00:30.
  - Provision of Regulated Entertainment is Monday to Wednesday until 00:00; Thursday to Saturday until 03:00; and Sunday until 01:00.
  - Opening hours for public are Monday to Wednesday until 00:30; Thursday to Saturday until 03:30; and Sunday until 01:00
- (v) Days before Bank Holidays and for Christmas Eve, one extra hour beyond the usual permitted hours are granted.
- X (vi) That two door supervisors be SIA approved and will be present between 22:00 and closing times.
- x(vii) No new admission to the premises after 00:00 every night.
- (viii) That CCTV be installed, maintained and operated on the premises for the duration of operating hours for the prevention of crime and disorder.
- (ix) That anti-drugs signs be displayed in the premises for the prevention of crime and disorder.
- (x) Signs for exiting customers to leave quietly for the prevention of public nuisance
- (xi) Conditions to restrict numbers in the premises to 50 in the restaurant and 150 in the bar area for the benefit of crime and disorder, public safety, and public nuisance objectives.

Annex 4 - Plans

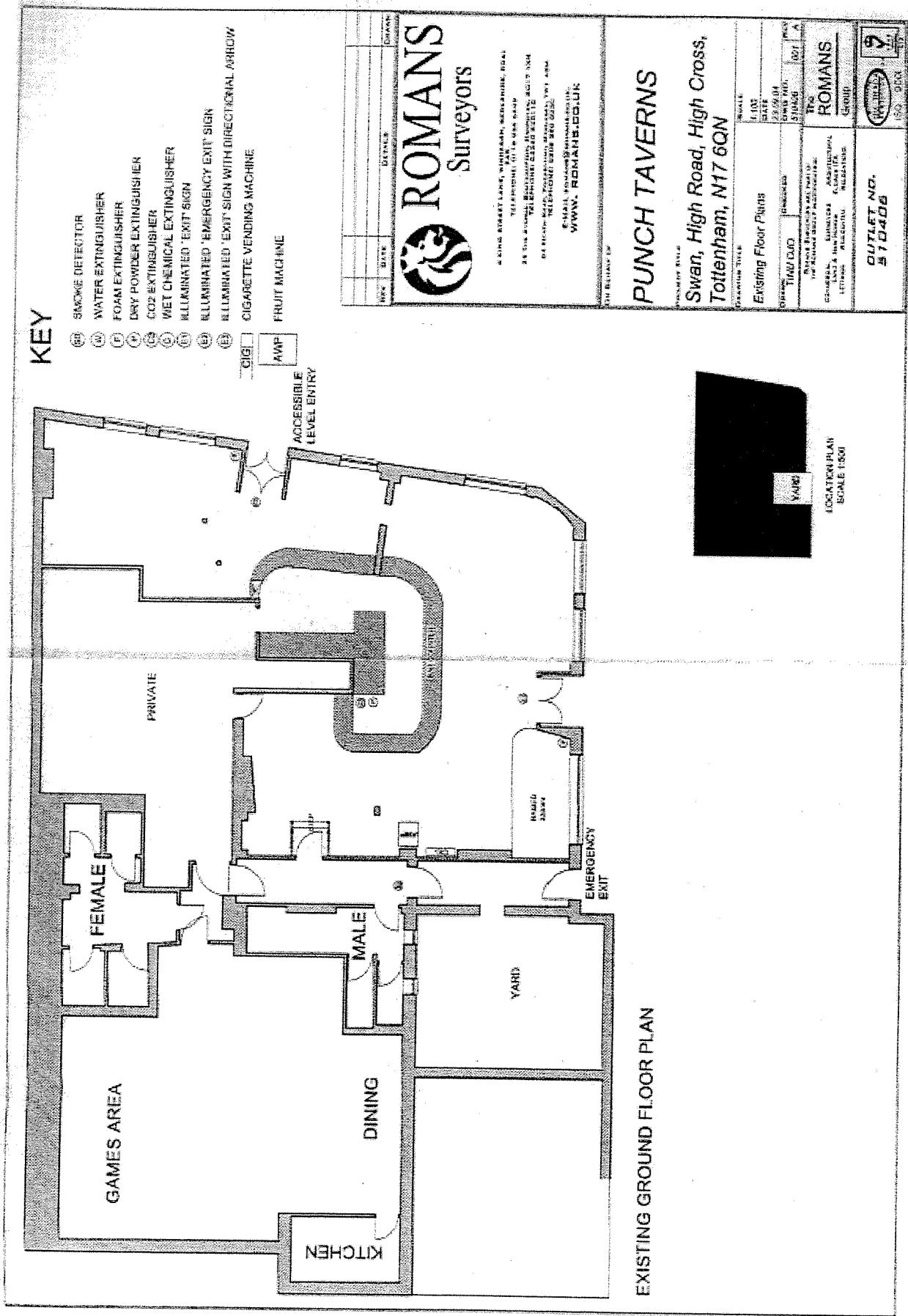

ROMANS  
Surveyors

8 KING STREET, WINDHAM, NORWICH, NOR  
 TEL: 01603 707180 FAX: 01603 707181  
 25 DE LA RUE, WINDHAM, NORWICH, NOR  
 TEL: 01603 707182 FAX: 01603 707183  
 64 BELTON ROAD, WINDHAM, NORWICH, NOR  
 TEL: 01603 707184 FAX: 01603 707185  
 E-MAIL: ROMANS@ROMANS.CO.UK  
 WWW.ROMANS.CO.UK

**PUNCH TAVERNS**

PROPERTY TITLE  
**Swan, High Road, High Cross,  
 Tottenham, N17 6QN**

PROJECT TITLE	Existing Floor Plans
DATE	1/10/04
SCALE	AS SHOWN
DESIGNED BY	ROMANS
CHECKED BY	ROMANS
DATE	1/10/04
PROJECT NO.	150-0104
CLIENT	ROMANS
GROUP	GROUP
OUTLET NO.	510406



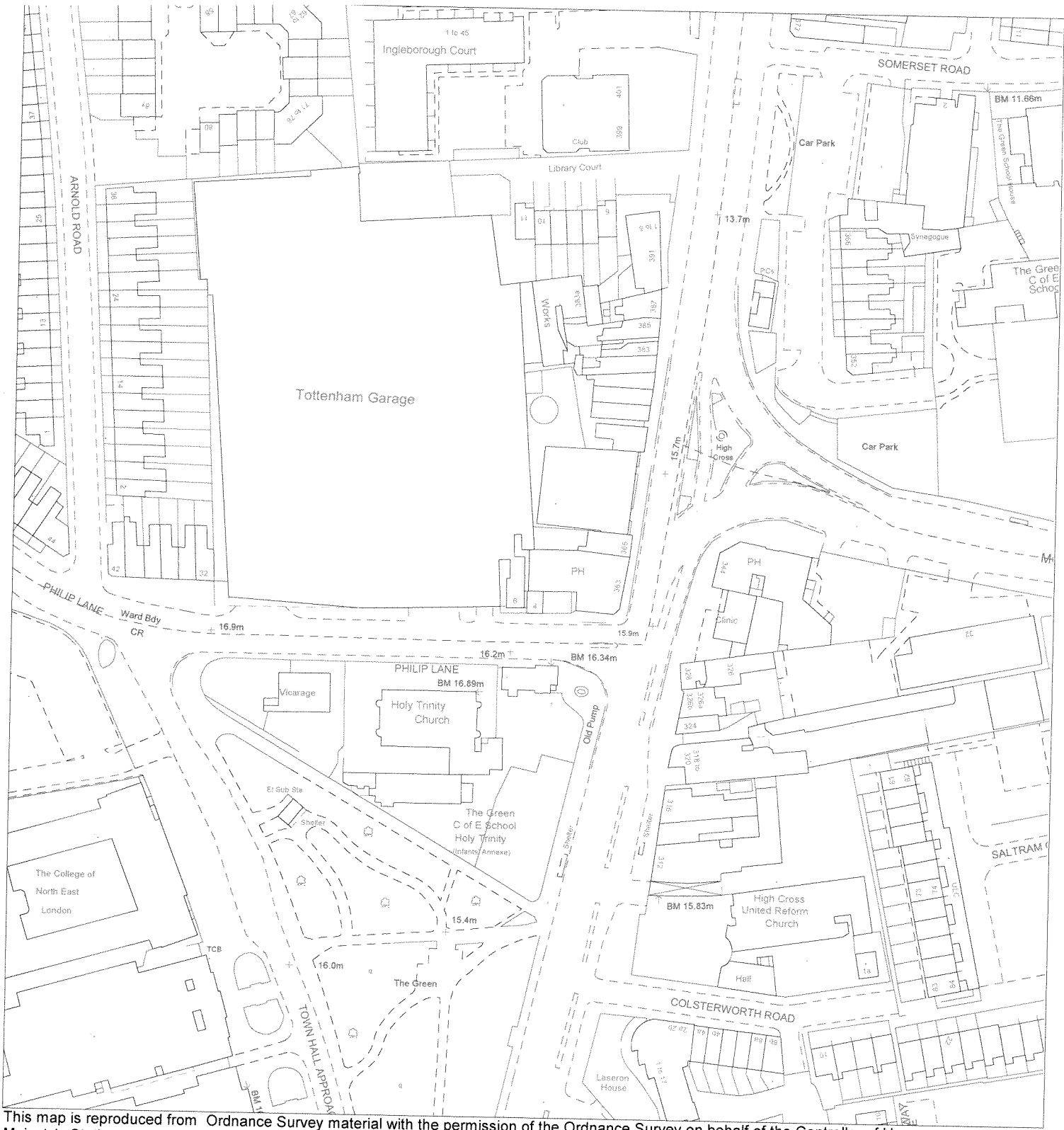

This map is reproduced from Ordnance Survey material with the permission of the Ordnance Survey on behalf of the Controller of Her Majesty's Stationery Office © Crown copyright. Unauthorised reproduction infringes Crown copyright and may lead to prosecution or civil proceedings. LB Haringey 100019199 2007

**Town and Country Planning Act 1990 (As amended)**

**Plan relating to the Enforcement Notice dated**

**THE SWAN PUBLIC HOUSE, 363 HIGH ROAD N17**

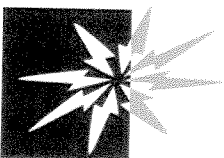

**Haringey Council**

Robin Payne  
 Assistant Director  
 Enforcement Service  
 639 High Road  
 Tottenham  
 N17 8BD

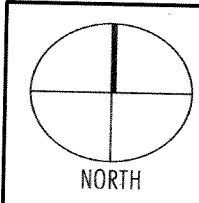

Drawn by	Haringey Council
Scale	1:1500
Date	20/11/2007
Drawing	N/A